

WELCOME

TO THE PUBLIC HEARING FOR

Northeast Gateway
Project Development and Environment
(PD&E) Study

Leon County, FL

Wednesday, May 26, 2021

WELCOME

TO THE PUBLIC HEARING FOR

Northeast Gateway
Project Development and Environment
(PD&E) Study

Leon County, FL

Wednesday, May 26, 2021

Purpose of the Public Hearing

- To allow the public an opportunity to review the recommended alternative for the NE Gateway project
- To inform the public of the project with a formal presentation
- To receive public input on the project
- Present the next steps in the project delivery process and associated timeline

Tonight's Agenda

Open House:
5:30 PM to 6:00 PM

Formal Presentation:
6:00 PM

Public Comment Period:
Following formal presentation

Title VI Compliance

Public participation is encouraged and solicited without regard to race, color, national origin, age, sex, religion, disability, or family status. Persons wishing to express their concerns about Title VI may do so by contacting:

Susan Emmanuel
Public Information Officer
Blueprint Intergovernmental Agency
315 S. Calhoun Street
Tallahassee, FL 32301
(850) 219-1060
Susan.Emmanuel@blueprintia.org

Public Hearing Notifications

- Mailed notification to more than 3,400 property owners and residents
- Emailed to more than 130 elected officials and stakeholders
- Noticed in the Tallahassee Democrat
- Noticed in the Florida Administrative Record
- Publicized on NEGateway.com
- Publicized on BlueprintIA.org

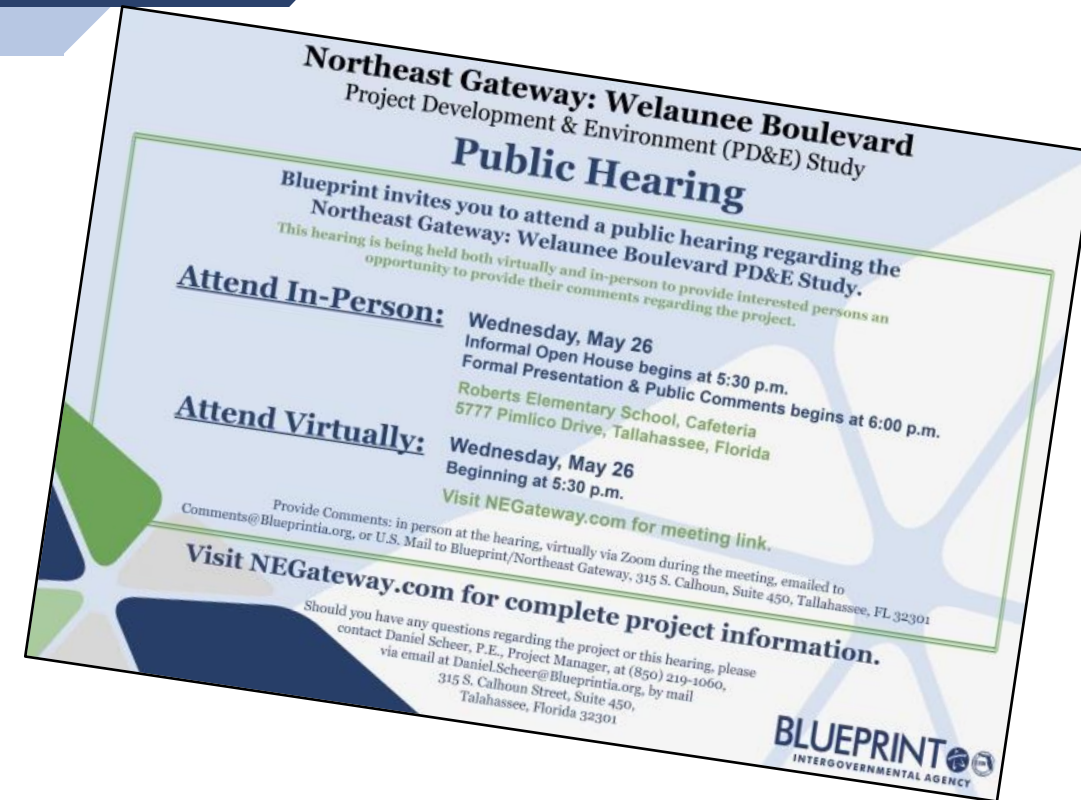

Summary Documents on Display

- May 11th through June 7th
- Blueprint Intergovernmental Agency Office
315 S. Calhoun St., Suite 450, Tallahassee, FL
Monday – Friday | 8:00 a.m. – 5:00 p.m.
- Northeast Branch Library – LeRoy Collins Leon County Public Library
5513 Thomasville Rd., Tallahassee, FL
Tuesday & Thursday | 11:00 a.m. – 8:00 p.m.
Wednesday & Friday | 10:00 a.m. – 6:00 p.m.
Saturday | 10:00 a.m. – 4:00 p.m.
- Available on NEGateway.com

State and Federal Regulations

- Section 120.525, Florida Statutes – Meetings, hearings, and workshops
- Section 286.011, Florida Statutes – Government in the Sunshine Law
- Section 335.199, Florida Statutes – Transportation projects modifying access to adjacent property
- Section 339.155, Florida Statutes – Transportation planning
- Americans with Disabilities Act of 1990 (ADA)
- Title VI of the Civil Rights Act of 1964 and Other Nondiscrimination Laws
- 49 CFR Part 24, Uniform Relocation Assistance and Real Property Acquisition for Federal and Federally-Assisted Programs
- 40 CFR Part 1506, Other Requirements of NEPA

Public Comments

Written comments received or postmarked no later than Monday, June 7, 2021 will become a part of the public record for the public hearing. All written comments should be mailed to:

Daniel Scheer, P.E.
Design and Construction Manager
Blueprint Intergovernmental Agency
315 S. Calhoun St., Suite 450
Tallahassee, FL 32301

Or emailed at: Daniel.Scheer@blueprintia.org



Comment Form

Northeast Gateway: Welaunee Boulevard Project Development and Environment (PD&E) Study

Complete this comment form and submit to Dan Scheer, P.E., Project Manager, by mail or email at Daniel.Scheer@BlueprintIA.org. For comment forms submitted by mail, please fold and mail to the address shown on the back of this form.

NOTICE: The information provided below is a matter of public record subject to examination by the general public upon request.

Name: _____

Address: _____

Phone: _____

E-mail: _____

Interest in project:

Self <input type="checkbox"/>	Firm / Agency <input type="checkbox"/>
Government Agency <input type="checkbox"/>	Civic Group <input type="checkbox"/>
Business Owner <input type="checkbox"/>	Other <input type="checkbox"/>

Comments:

Northeast Gateway Project Purpose and Need

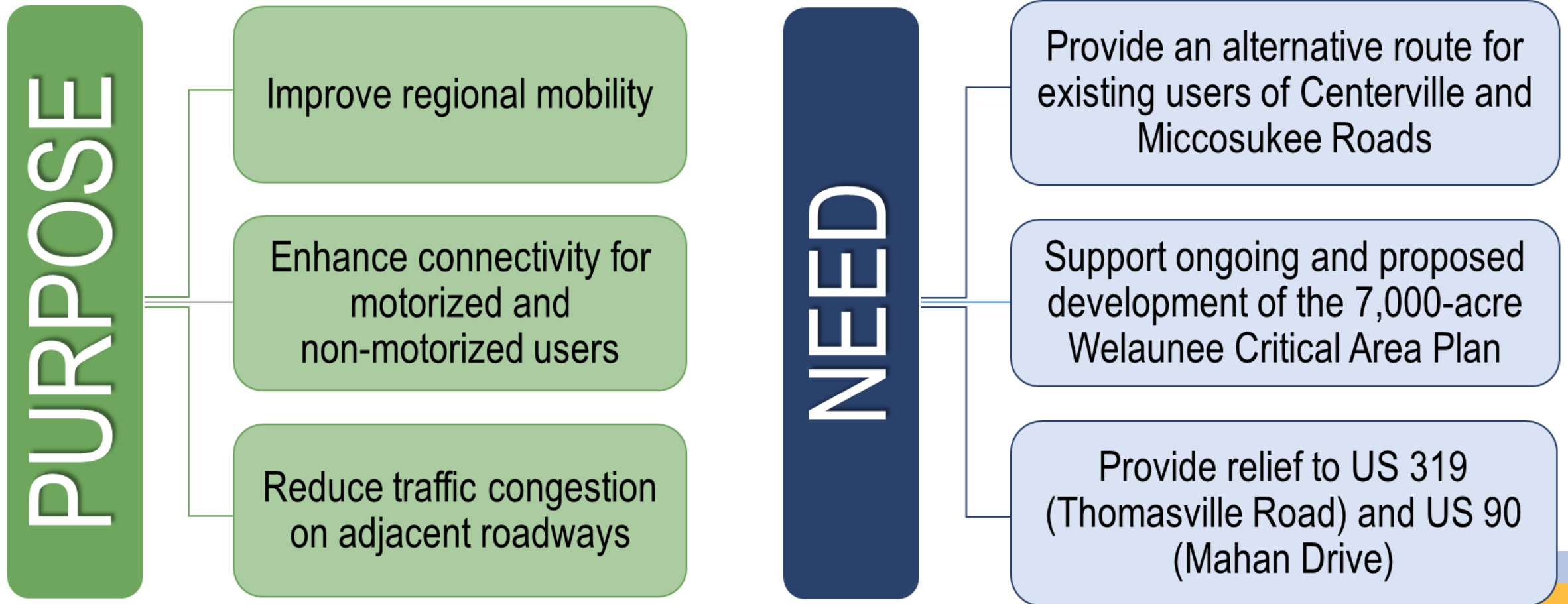

Study Area and Recommended Alignment

- Southern Terminus:
Welaunee Boulevard at
Canopy PUD/City PUD
Boundary
- Northern Terminus:
Shamrock Street South at
Centerville Road &
Welaunee Boulevard at
Roberts Road

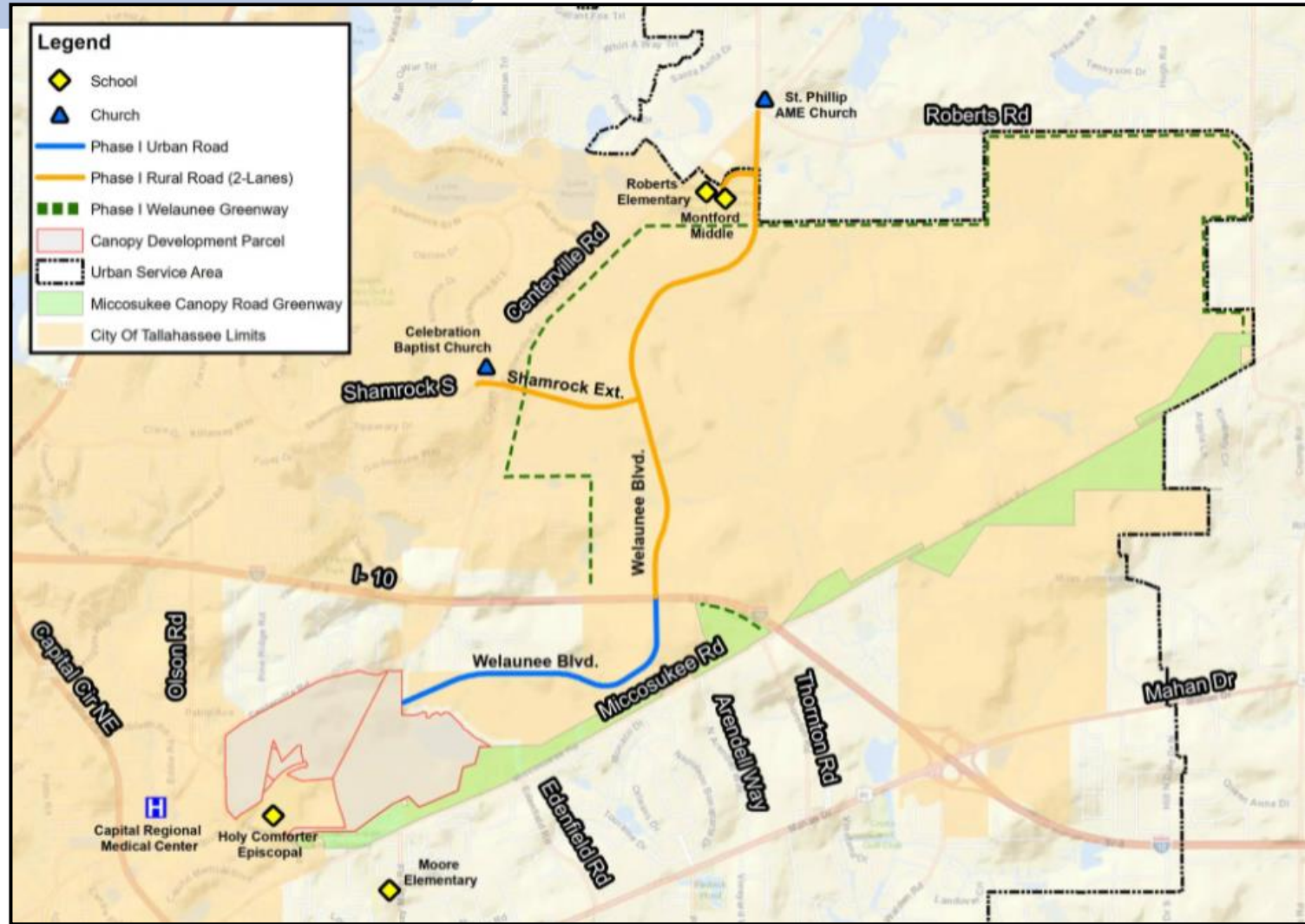

Community Engagement Overview

Blueprint Community Events

- March 11, 2019, Project Kickoff Holy Comforter Epis. School
- North Town Getdown
- Tallahassee Farmer's Market
- Tallahassee Heights UMC Pumpkin Patch
- December 3, 2019, Traffic Modeling Session, Montford Middle School
- December 3, 2019, BP TCC, Blueprint Conf Room
- December 4, 2019, Grow Tallahassee, Midtown
- December 5, 2019, BP CAC, Myers Park
- February 4, 2020, Aux. Noise Study, Holy Comforter Epis. School
- August 25-27, 2020, Virtual Project Update
- February 27, 2021, Pop-Up Event, Bannerman Crossing
- February 24-25, 2021, Virtual Engagement - Operations

Public Hearings

- January 16, 2020 –Leroy Collins Public Library
- January 30, 2020 –Tallahassee City Hall

Stakeholder Meetings

- Killearn Homeowners Association
- Keep it Rural
- Florida Department of Transportation
- Panhandle Archaeological Society of Tallahassee
- Buckhead Homeowners Association
- City of Tallahassee Underground Utilities and Public Infrastructure & City of Tallahassee Electric
- Leon County Public Works
- Property Owners south of I-10
- Leon County School Board
- Property Owners (Lang, Bailey, Archibald, Powerhouse, Suber, Kennerly, Cooper, Celebration Baptist, etc.)
- CeRCA / Apalachee Land Conservancy / Tall Timbers
- St. Phillips AME Church
- Canopy Roads Committee

Door – to – Door

- Along Pemberton Road

Project Timeline

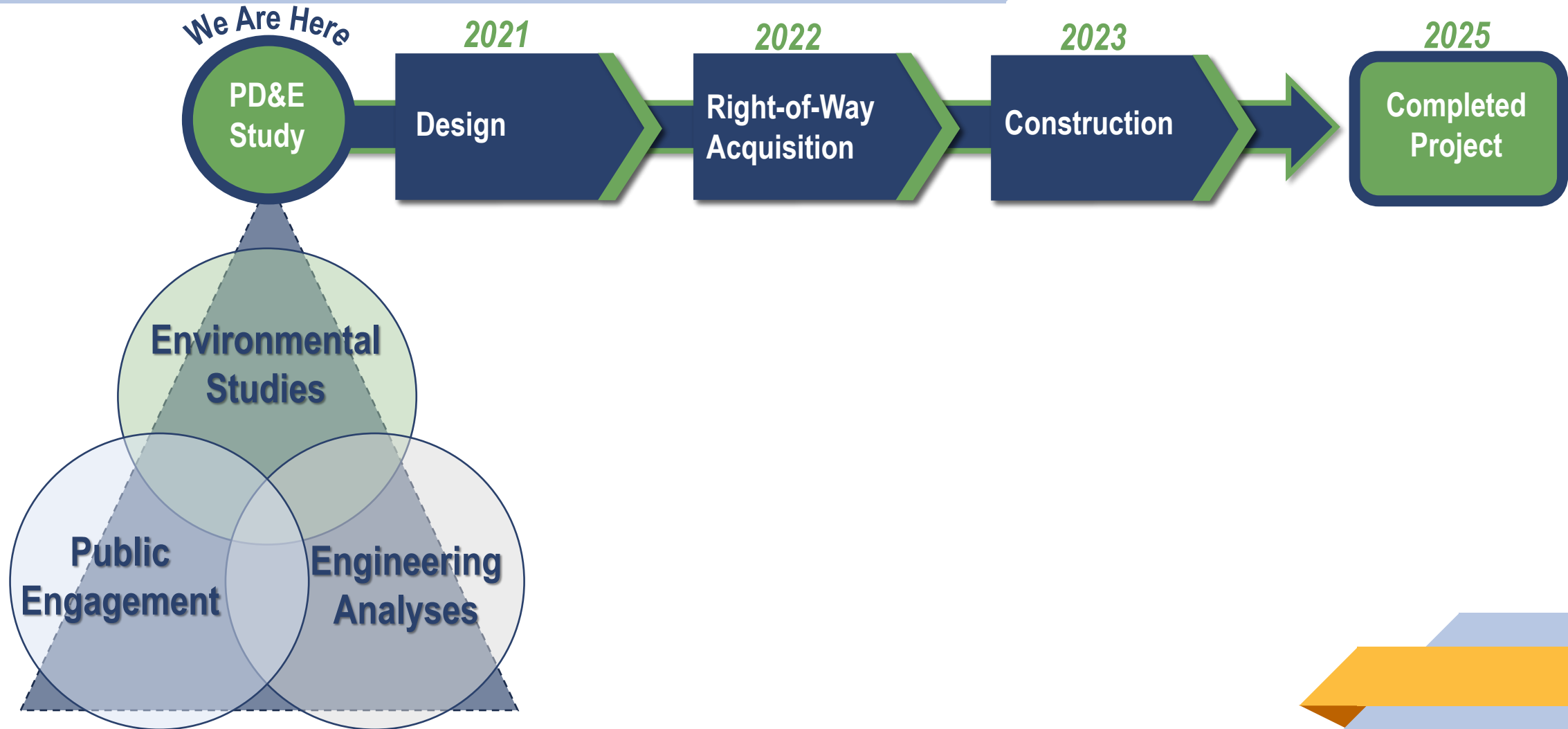

PD&E Technical Studies

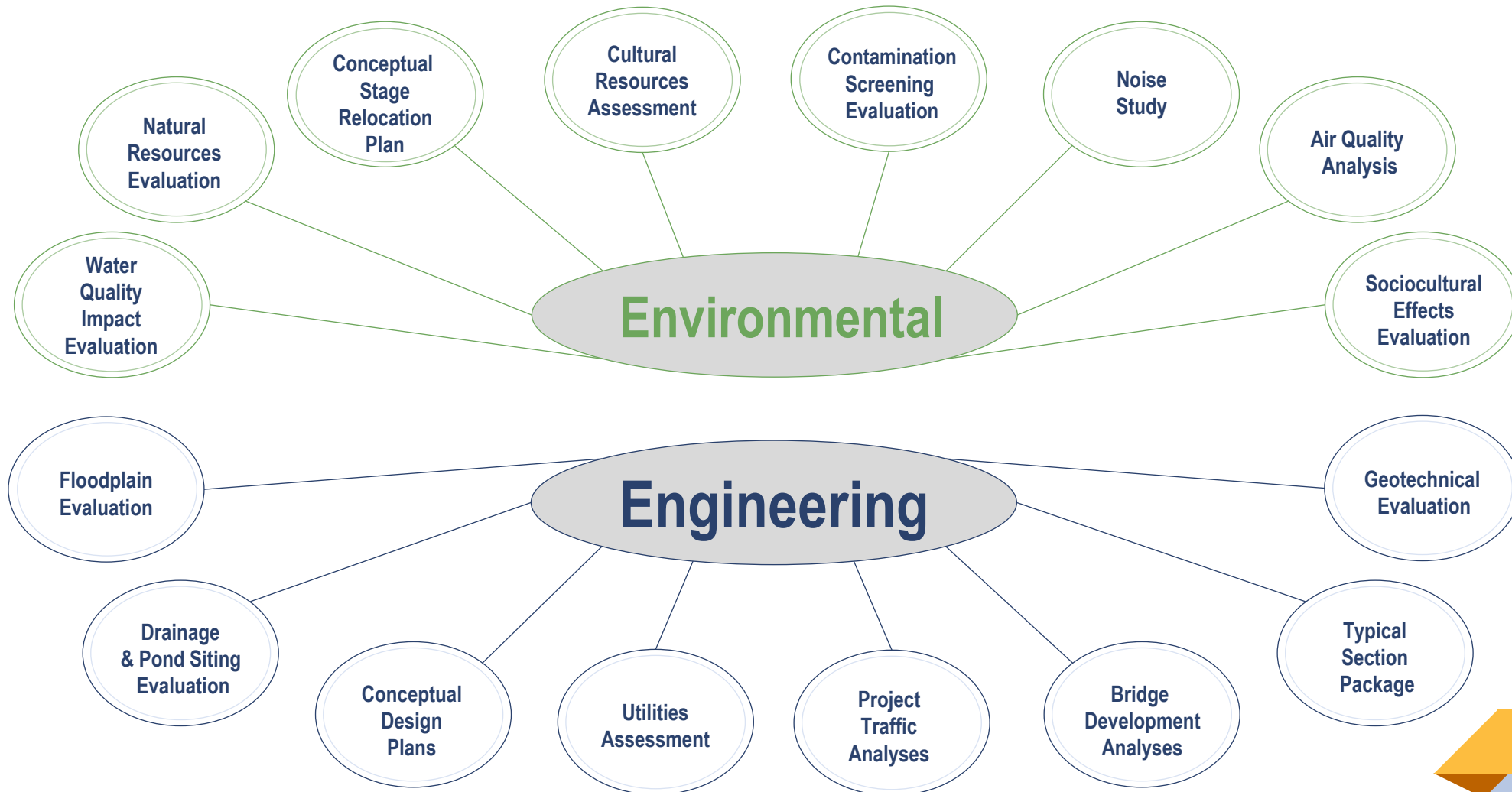

Northeast Gateway – PD&E Typical Sections

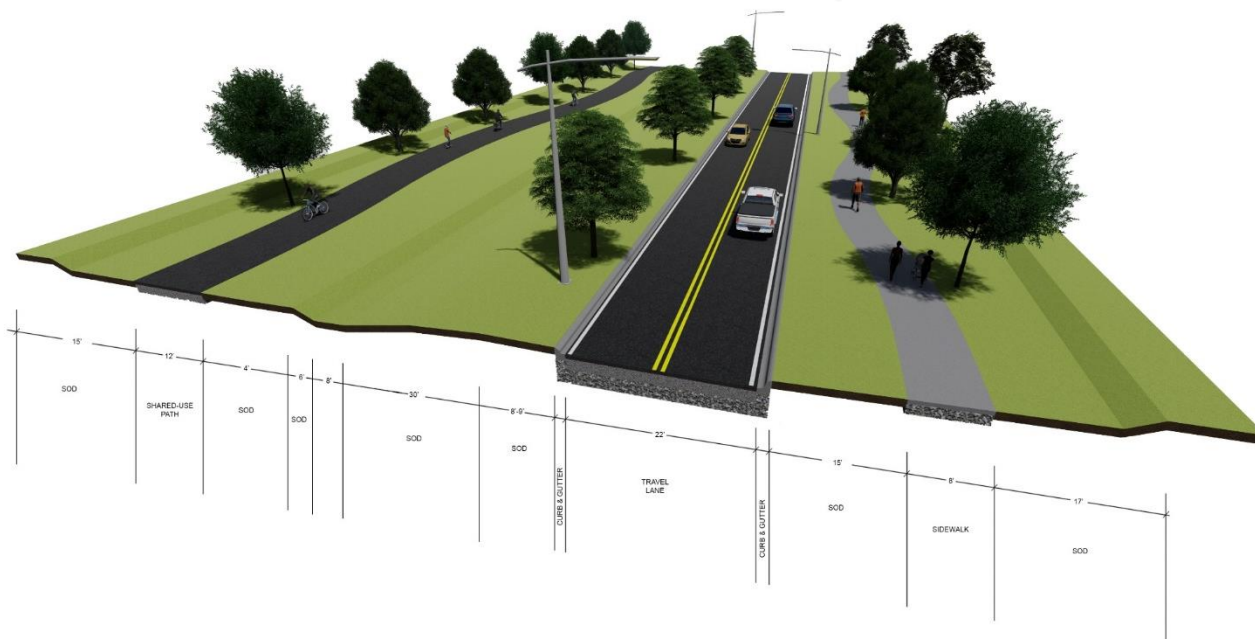

Northeast Gateway - Alternative Typical Sections

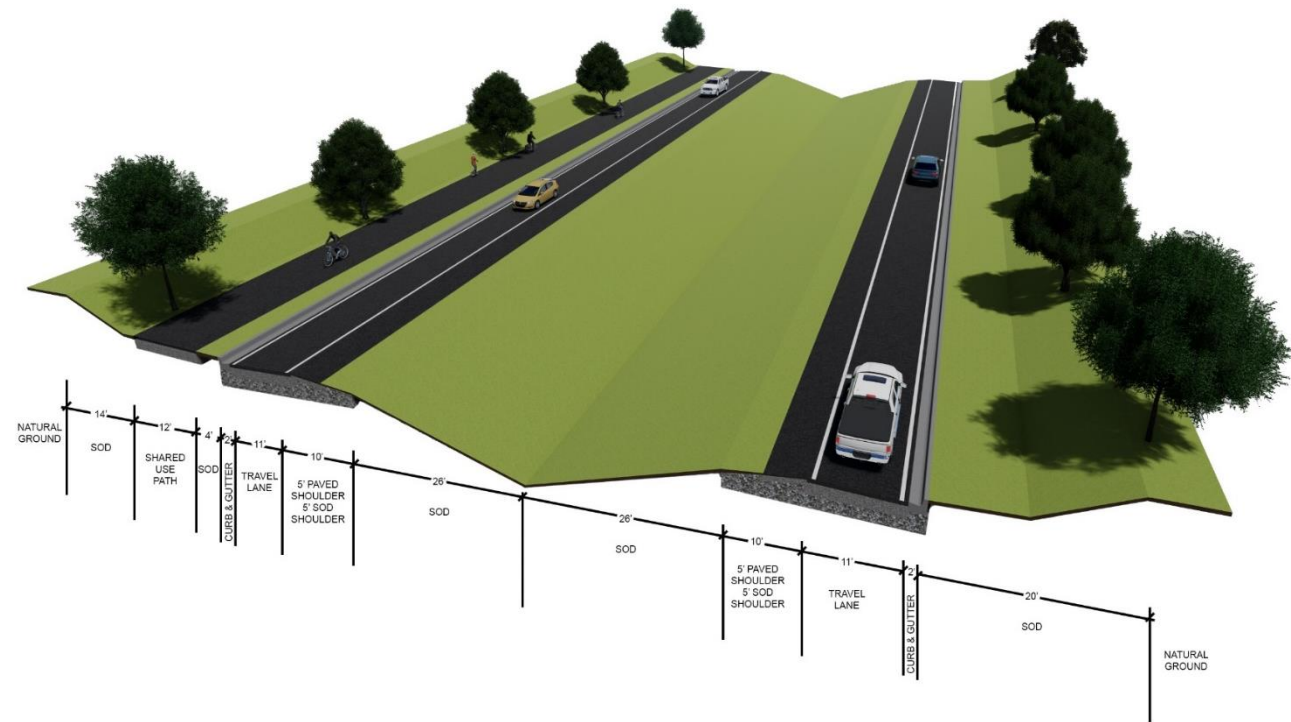
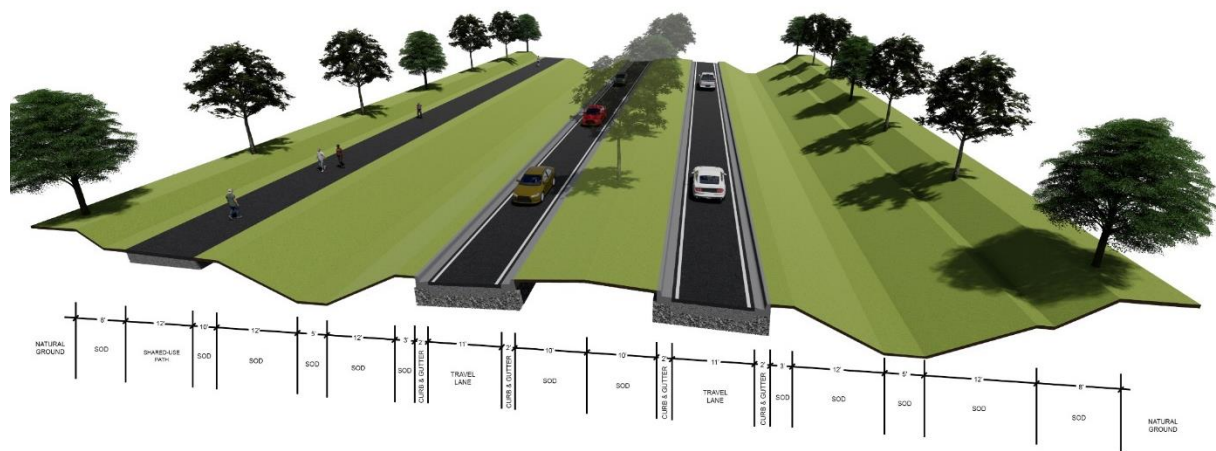

Shamrock Street Extension – PD&E Typical Section

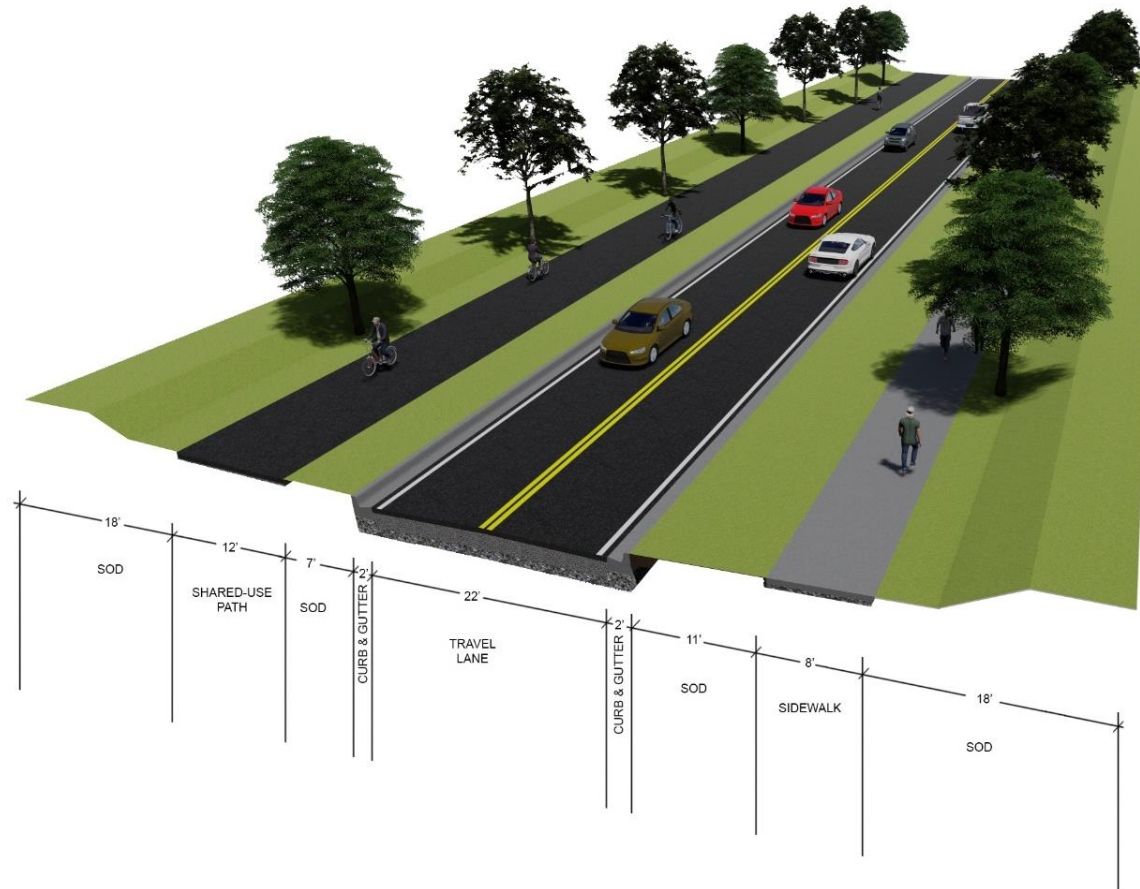

I-10 Crossing Bridge – PD&E Typical Section

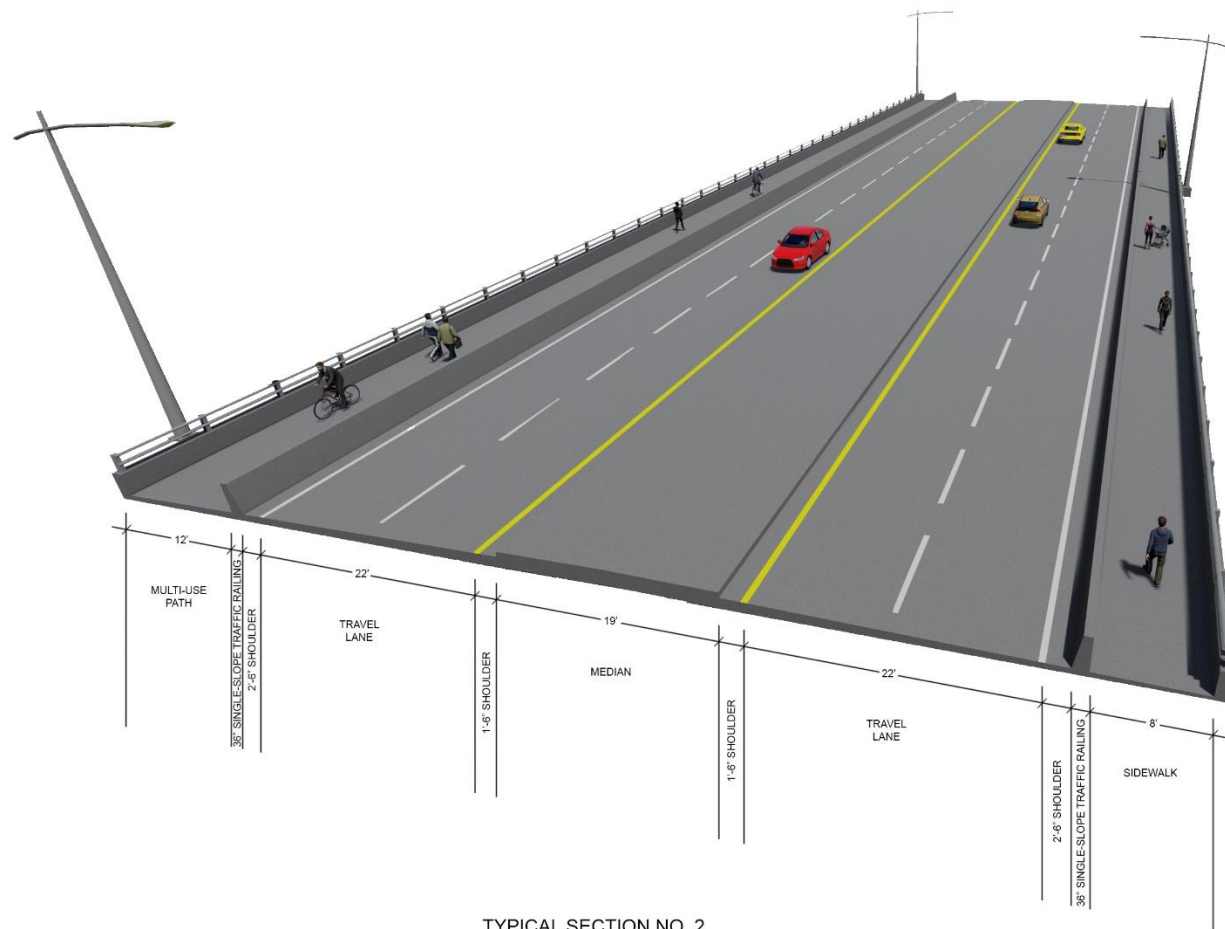

TYPICAL SECTION NO. 2

Wetland/Floodway Crossing Bridges – PD&E Typical Sections

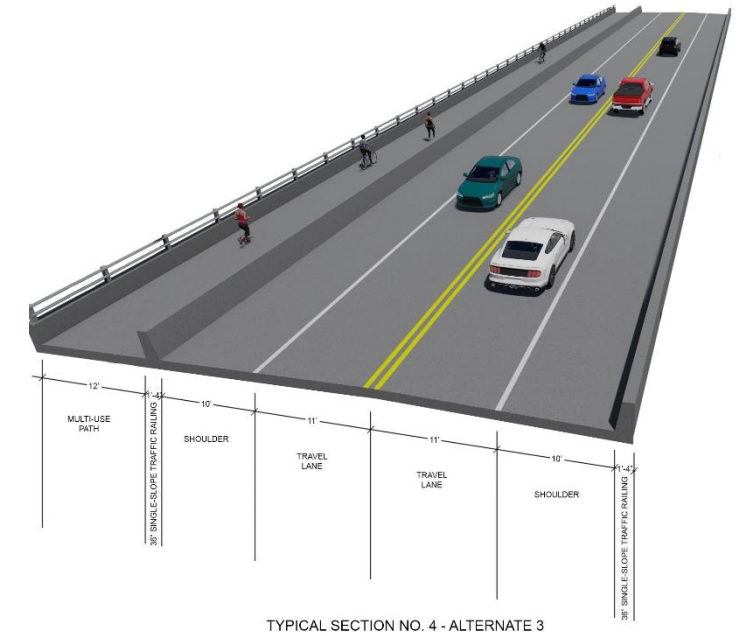
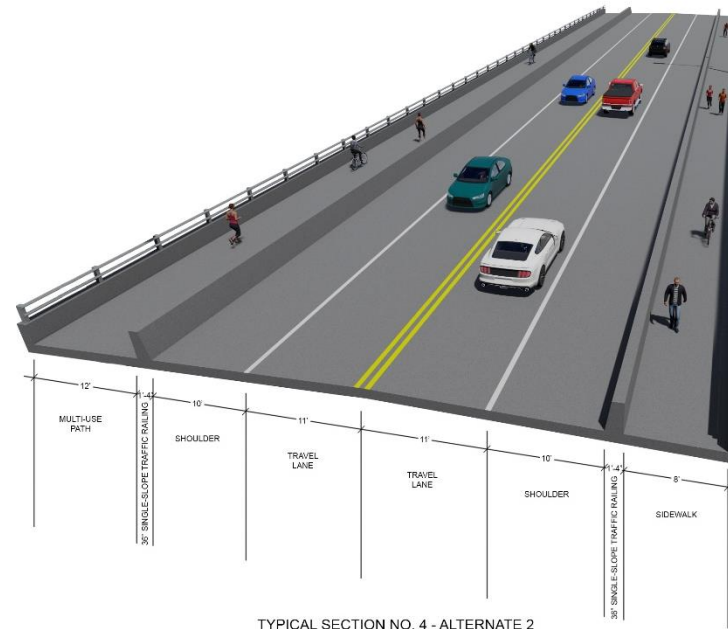
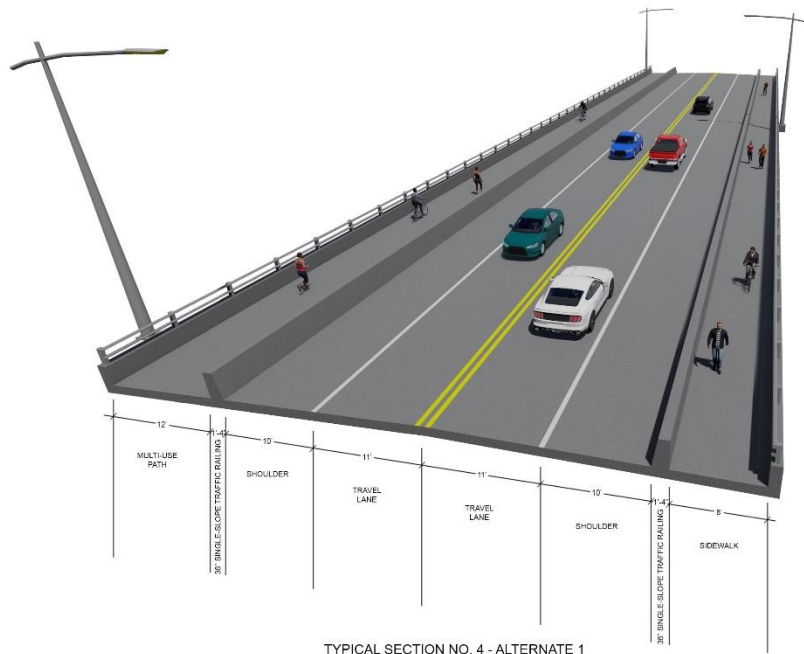

PD&E Environmental Summary

ANALYSIS SUMMARY MATRIX		
CATEGORY	Alternative	
	No Build	Build
ENVIRONMENTAL		
Wetlands/Surface Waters	No Involvement	1.62 acres
Stormwater/Drainage	None	9 ponds
Threatened & Endangered Species	No Involvement	Minimal Involvement
Contamination	No Involvement	6 Potential Sites: Low Risk Rating
Air Quality	Reduced Due to Congestion	Improved with Congestion Relief and Roundabout Implementation
Noise	No Impact	No Impacted Sites
Floodplains	No Involvement	3.46 acres
Trees/Forests	No Involvement	11.5 acres
Cultural/Historical/Archaeological	No Impact	No Effect

Cultural Resources Studied

- Evaluated 9 Resources
 - Three previously unrecorded historic buildings
 - One previously recorded multiple group resource
 - Two previously recorded historic cemeteries
 - One previously unrecorded cemetery
 - Two archaeological historic artifact scatters



**St. Phillip AME Church
-Front (east) elevation-**

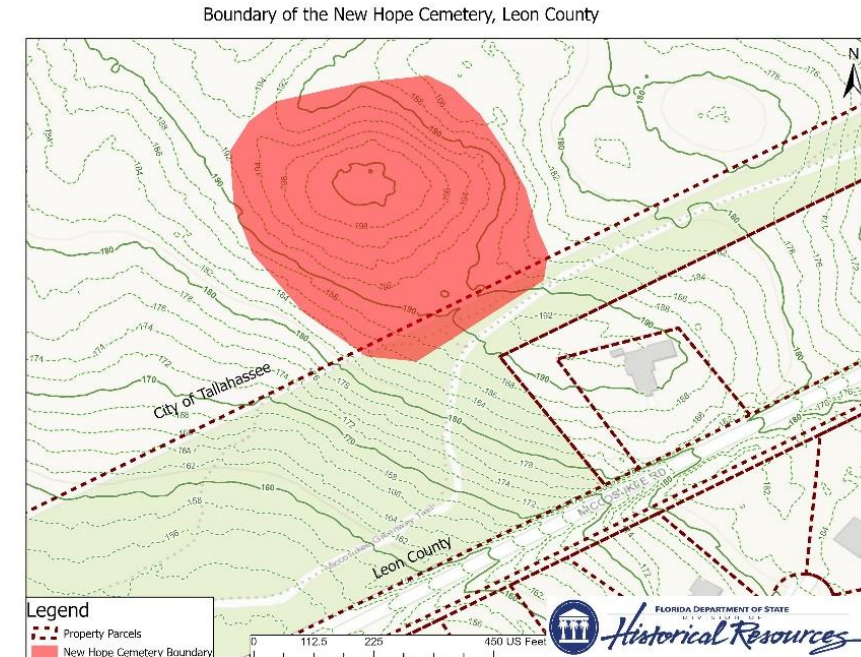

Project Economic Impact Summary

- Study prepared by FSU's Center for Economic Forecasting and Analysis
 - Economic impact directly related to construction is estimated at ~\$104.6M
 - Estimated to create 650 jobs
- Opening year (2025)
 - Saves approx. \$2.0M in vehicle maintenance and fuel costs
- Design year (2045)
 - Saves approx. \$4.8M in vehicle maintenance and fuel costs
- Supports economic development
 - Development generates \$2.2B to \$8.2B in total economic
 - Economic growth results in \$263M to \$1.0B in additional tax receipts

No-Build vs. Build Alternative

	Advantages	Disadvantages
No-Build Alternative	<ul style="list-style-type: none">• No impacts to social, natural, or built environment• No right-of-way needed	<ul style="list-style-type: none">• Does not meet the project's purpose and need• No relief to existing parallel roadways or enhanced mobility for non-motorized users• No additional connections to existing and planned future development• No potential for future I-10 Interchange• Does not support planned development or economic growth and job creation
Build Alternative	<ul style="list-style-type: none">• Meets the project's purpose and need• Enhances mobility for both motorized and non-motorized users• Supports planned development• Provides connection to future NE Park• Provides additional connection to Schools• Opportunity for future I-10 Interchange• Creates jobs, increases tax base, and provides economic savings for existing motorists	<ul style="list-style-type: none">• Minimal impacts to social, natural, and physical environment• Minimal right-of-way needs with no relocations needed

Moving Forward



Northeast Gateway: Welaunee Boulevard Project Schedule

[illegible]

Written Comments

Written comments received or postmarked no later than Monday, June 7, 2021 will become a part of the public record for the public hearing. All written comments should be mailed to:

Daniel Scheer, P.E.
Design and Construction Manager
Blueprint Intergovernmental Agency
315 S. Calhoun St., Suite 450
Tallahassee, FL 32301

Or emailed at: Daniel.Scheer@blueprintia.org



Comment Form

Northeast Gateway: Welaunee Boulevard Project Development and Environment (PD&E) Study

Complete this comment form and submit to Dan Scheer, P.E., Project Manager, by mail or email at Daniel.Scheer@BlueprintIA.org. For comment forms submitted by mail, please fold and mail to the address shown on the back of this form.

NOTICE: The information provided below is a matter of public record subject to examination by the general public upon request.

Name: _____

Address: _____

Phone: _____

E-mail: _____

Interest in project:

Self	<input type="checkbox"/>	Firm / Agency	<input type="checkbox"/>
Government Agency	<input type="checkbox"/>	Civic Group	<input type="checkbox"/>
Business Owner	<input type="checkbox"/>	Other	<input type="checkbox"/>

Comments:

Public Comment Period

- Pre-registered Virtual Attendees
- In-person Attendees
- State your name and address for the record
- Will have up to three minutes to make a statement
- All statements, comments, and questions will be responded to in writing following the Public Hearing comment period, which ends June 7, 2021.



Thank you for attending.

Your participation is a critical component of the Blueprint Program.

Contact Information:

Daniel Scheer, P.E.
Design and Construction Manager
(850) 219-1060
Daniel.Scheer@blueprintia.org

Susan Emmanuel
Public Information Officer
(850) 219-1060
Susan.Emmanuel@blueprintia.org

